

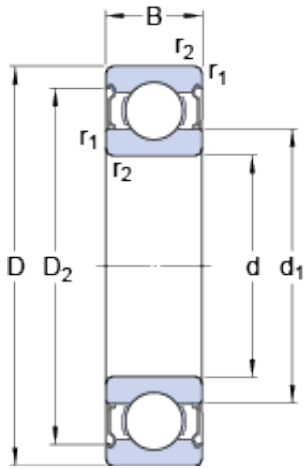

AFEX Bearing Equipment Co., Ltd.



6213-2Z Bearing 2D drawings and 3D CAD models

65 mm x 120 mm x 23 mm SKF 6213-2Z Deep groove ball bearing 6213-Z Bearings size: 65x120x23 mm 6213-2Z/C3

Bearing No. 6213-2Z

Size	120x65x23 mm
Bore Diameter	120 mm
Outer Diameter	65 mm
Width	23 mm
d	65 mm
D	120 mm
B	23 mm
d ₁	83.3 mm
D ₂	105.8 mm
r _{1,2} - min.	1.5 mm
d _a - min.	74 mm
d _a - max.	83.2 mm
D _a - max.	111 mm
r _a - max.	1.5 mm
Basic dynamic load rating - C	58.5 kN
Basic static load rating - C ₀	40.5 kN
Fatigue load limit - P _u	1.7 kN
Reference speed	12000 r/min
Limiting speed	6000 r/min
Calculation factor - k _r	0.025
Calculation factor - f ₀	14.7
Category	Single Row Ball Bearings
Inventory	0.0



AFEX Bearing Equipment Co., Ltd.

Manufacturer Name	SKF
Minimum Buy Quantity	N/A
Weight / Kilogram	1.06
EAN	7316570464719
Product Group	B00308
Enclosure	2 Metal Shields
Precision Class	ABEC 1 ISO P0
Maximum Capacity / Filling Slot	No
Rolling Element	Ball Bearing
Snap Ring	No
Internal Special Features	No
Cage Material	Steel
Internal Clearance	C0-Medium
Inch - Metric	Metric
Long Description	65MM Bore; 120MM Outside Diameter; 23MM Outer Race Diameter; 2 Metal Shields; Ball Bearing; ABEC 1 ISO P0; No Filling Slot; No Snap Ring; No Internal Special Features
Category	Single Row Ball Bearing
UNSPSC	31171504
Harmonized Tariff Code	8482.10.50.68
Noun	Bearing
Keyword String	Ball
Manufacturer URL	http://www.skf.com
Manufacturer Item Number	6213-2Z
Weight / LBS	2.34
Bore	2.559 Inch 65 Millimeter
Outside Diameter	4.724 Inch 120 Millimeter
Outer Race Width	0.906 Inch 23 Millimeter
d ₁	83.3 mm



AFEX Bearing Equipment Co., Ltd.

D_2	105.8 mm
$r_{1,2}$ min.	1.5 mm
d_a min.	74 mm
d_a max.	83.2 mm
D_a max.	111 mm
r_a max.	1.5 mm
Basic dynamic load rating C	58.5 kN
Basic static load rating C_0	40.5 kN
Fatigue load limit P_u	1.73 kN
Calculation factor k_r	0.025
Calculation factor f_0	14.7
Mass bearing	1.06 kg